

# Membrane expansion vessels



**Expansion vessels with fixed air cushion**

from 6 L to 100 L

*Engineering  
GREAT Solutions*

# Membrane expansion vessels

The MN Vessel Range with fixed membrane is ideal for small heating and cooling systems up to 100 L in renovation or new build projects. The range has a simple design and robust construction.

## Key features

- > **Range of vessel sizes available for different system needs**  
from 6L to 100L
- > **Thick SBR Membrane adhering to EN 13831 standard**  
ensures minimal diffusion of air into the system.
- > **Resilient steel body**  
ensures vessel longevity
- > **Small vessels**  
6L to 50L can be easily wall mounted



## Technical description

### Applications:

Heating and cooling systems.

### Media:

Non-aggressive and non-toxic system media.  
Addition of antifreeze agent up to 49%.

### Pressure:

Min. admissible pressure, PS<sub>min</sub>: 0 bar  
Max. admissible pressure, PS: see Articles

### Operating temperature:

- 10°C - +100°C

### Material:

Vessel: Steel  
Rubber membrane: SBR

### Function, Equipment, Features

Fixed membrane according to EN 13831 vessel types MN-6 to MN-24: with bracket for easy wall hanging available.  
Vessel type MN-35 and MN-50: with feet for easy wall hanging or upright installation.  
Vessel types MN-80 to MN-100: for upright installation only.

### Transportation and storing:

In frostless, dry places.

### Approvals:

CE design-tested according to PED/DEP 97/23/EC.

## Articles

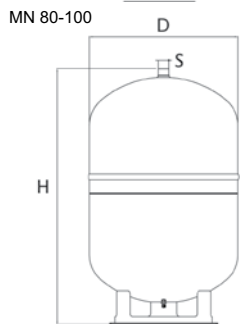
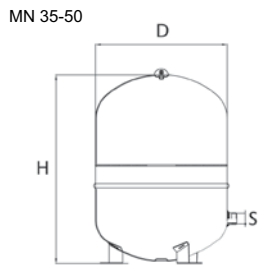
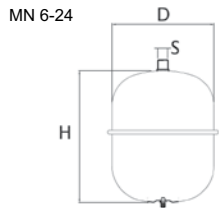

### Membrane Expansion Vessel MN

Type	VN [l]	p0 [bar]	D	H	Kg	S	EAN	Article No
<b>Max working pressure 3,5 bar</b>								
MN-6	6	1,5	245	250	2,10	M3/4"	8033003532874	11110-015006
MN-8	8	1,5	245	280	2,30	M3/4"	8033003532881	11110-015008
MN-10	10	1,5	245	330	2,55	M3/4"	8033003532898	11110-015010
MN-12	12	1,5	285	325	3,10	M3/4"	8033003532904	11110-015012
MN-18	18	1,5	285	395	3,60	M3/4"	8033003532911	11110-015018
MN-24	24	1,5	325	420	5,00	M3/4"	8033003532928	11110-015024
<b>Max working pressure 6,0 bar</b>								
MN-35	35	1,5	380	435	6,15	M3/4"	8033003532935	11111-015035
MN-50	50	1,5	380	565	7,40	M3/4"	8033003532942	11111-015050
MN-80	80	1,5	460	690	12,40	M3/4"	8033003532959	11111-015080
MN-100	100	1,5	460	810	14,00	M3/4"	8033003532966	11111-015100

## Accessories for pressure maintenance



### Bracket

For Vessel Types MN-6 to MN-24

Type	W	H	Kg	EAN	Article No
with band, screw and fischer	107	90	0,24	8033003533109	15101-000002



### Shut-off valve

Type	PS [bar]	Connections	W	H	Kg	EAN	Article No
for MN-vessels, 3/4"	10	FM 3/4"	70	100	0,34	8033003533093	15101-000001